



- HOME/ MRL/
SINGLE PHASE ELEVATORS
- HOSPITAL/ BED ELEVATORS
- GOODS/ FREIGHT ELEVATORS
- HYDRAULIC ELEVATORS
- GLASS/ CAPSULE ELEVATORS

CREATIVE • INNOVATION • PROCESS



BHARAT ELEVATORS

📍 Rz -7, Part - 3, Near Durga Mandir, Uttam Nagar West , Delhi 110059

☎ +91-99961-21234, 96505-55409

✉ bharatelevators25@gmail.com



BHARAT ELEVATORS

Bharat Elevators is a unit of Omaxe india pvt. ltd. founded in 1997, dedicated to the installation, renovation, and maintenance of all makes and models of elevators. We have the best means and qualified personnel, being able to offer a more personal and direct treatment at a more advantageous cost without lowering the quality of service. We can satisfy at all times the objective of our clients : products and services with high-quality standards, reducing production, installation, and after-sales costs.



BHARAT ELEVATORS, we consolidate ourselves as manufactures of Home, passenger, Hospital, Hydraulic, Capsule and Cargo lifts. High-quality vertical transportation engineering and beauty in design are the governing values behind our high-quality products, We have a wide catalog of elevators for all requirements. All of our solutions are delivered ready for operation. We are a New Delhi based company dedicated to the design, manufacture, and assembly of equipment that offers special solutions for the movement, lifting, and storage of application materials in companies in the public and private sectors. We manufacture products according to individual need with high-quality standards, reliable technical specifications, and great functionality and safety.



BUILT FOR SAFETY, DESIGNED FOR YOU.

BHARAT ELEVATORS

Rz -7, Part - 3, Near Durga Mandir, Uttam Nagar West , Delhi 110059
+91-99961-21234, 96505-55409



HOME/ MRL/ SINGLE PHASE ELEVATORS

Single phase elevator is mostly required in public and private buildings also known as Home lift/Bungalow lift. The term used for a lift enclosed in a shaft and can move vertically as much as 15m(50ft.). Elderly and impaired people can use it to move autonomously without using stairs.

Advantages

Advantages of Single Phase Elevator By Bharat Elevators

- Single Phase Elevator are becoming popular day by day as builders and buyers have found it advantages.
- **INVESTMENT** : Home Elevators are a great expenditure letting you age with your home never sacrificing access
- **CHEAP** : Single Phase Elevator don't levy as much as you may think and can be custom-made to a great extent, meeting your requirements.
- **TECHNOLOGY** : It uses modern technology don't even disturb your house hold base as they rest on the floor of your house with nominal elevator kit and slide.
- **AVAILABILITY** : Single Phase Elevator are available in many finishes including beautiful hardwood and numerous other options to blend completely without disturbing your home decor.
- **EFFICIENCY** : Single Phase Elevator are an efficient use of land having high load bearing ratio and are energy efficient. Machine Room Less Elevators for home are ideal from the aspect of protection and reliability.
- **QUALITY** : These kind of elevators increase the value of a home as much as 10% and are excellent means to impress your guests with its classic or contemporary interiors and rich technical features.
- **CONVENIENT** : These elevators can also used to carry groceries or laundry between the floors of a multi storey home or a bungalow.

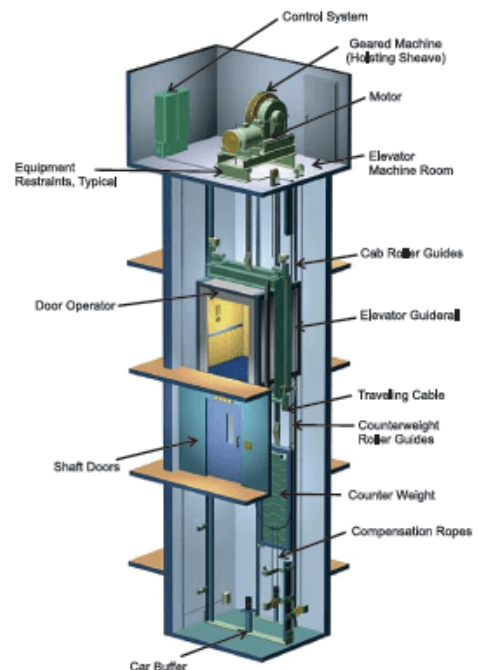

Technical information

Technical information on single phase elevator :

These elevators are fitted within the lift shaft and does not need a machine room as they are gearless type. It works on Single phase currently supply. the maximum number of floor is 5 that it covers. The capacity of this elevator is up to 300 kilograms. A small unit is required for accommodating hydraulic unit.





MRL - PASSENGER ELEVATORS

MRL Series Passenger Elevator adopts a design with a larger space on the roof of the cabin for inspection, providing greater safety protection to the operators when adjusting the Elevators. These kind of Elevators adopts double locks in the cabin, with a design on the platform more convenient for inspection.

Advantages

Advantages of MRL - Passenger Elevators by Bharat Elevators

➤ **Advantages in Building Applications** - Passenger Elevator MRL series can be suitable for small residential apartment, Office buildings, hotels. Exhibition, shops, art galleries, restaurants, car dealerships, etc.

➤ **MODULARITY** : These kinds of elevators work as the solution provider to add elevators to the house, we have different designs according to the old style of the building and customer requirements, circular and square panoramic elevators installed in a single wall, contributing so to modernity.

➤ **INSTALLATION** : It only needs two professional workers to finish the installation of 6 stops/ 6 plants with in 5 days, this option has the basic competitive capacity taking into account that at present the cost of work is increasingly expensive. These elevators has a fixed structure and an adjustable frame, which makes the installation process easier, we can even offer the customer the frame installation samples.

➤ **Environmental Protection** : It has environmentally-friendly LED lighting in the elevator, this is better for energy conservation. Also as aesthetic and practical, it installs the gearless traction machine with permanent magnet technology that does not require any maintenance or lubrication, so there is no hydrocarbon contamination. the motor power is less than 3 kw, which favors the conservation of energy and protection of the environment.

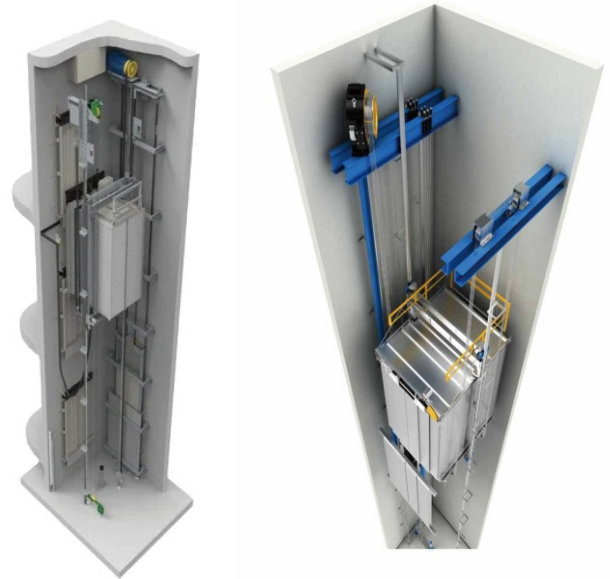

Technical information

Facilitating the elevator operation and gearless traction machine replacement. These elevators place the machine frame and the traction machine on top of the guide rail, so the static load and dynamic load of the system are generally supported by the guide rail, therefore less requirement for the wall in the building opening and greater safety in operation.

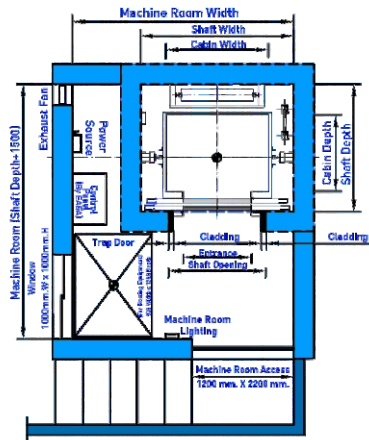
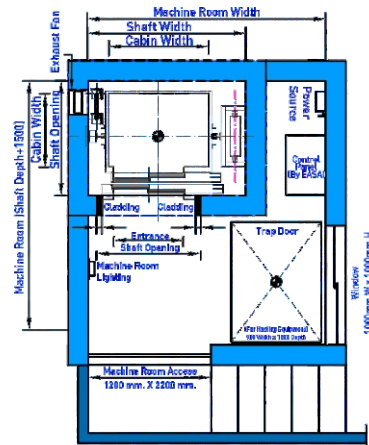
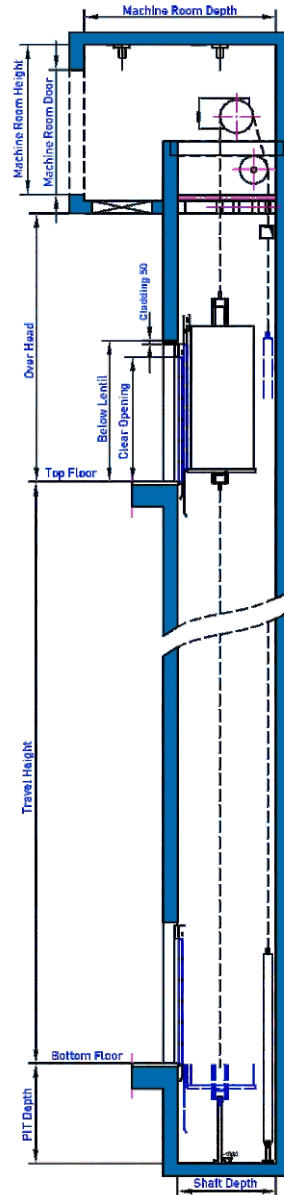

PASSENGER ELEVATOR (WITH MACHINE ROOM)

**LIFT WELL & MACHINE ROOM PLAN
(CENTER OPENING DOORS)**

(TELESCOPIC SIDE OPENING DOORS)

**LIFT WELL ELEVATION
(SIDE OPENING)**

CAPACITY		CAR INSIDE (Center Opening)		LIFT WELL (Center Opening)		CAR INSIDE (Side Opening)		LIFT WELL (Side Opening)		ENTRANCE	SHIFT OPENING
PERSONS	Kgs.	WIDTH	DEPTH	WIDTH	DEPTH	WIDTH	DEPTH	WIDTH	DEPTH		
4	272	800	900	1600	1350	800	900	1400	1400	700	1040
5	340	1000	900	1600	1350	1000	900	1550	1400	700	1040
6	408	1000	1100	1800	1500	1000	1100	1550	1550	800	1140
		1100	1000	1800	1450	1100	1000	1650	1450	800	1140
7	476	1200	1050	1800	1450	1200	1050	1800	1500	800	1140
8	544	1100	1300	1800	1650	1100	1300	1700	1700	800	1140
		1200	1200	1800	1600	1200	1200	1800	1600	800	1140
9	612	1200	1350	1800	1800	1200	1350	1800	1800	800	1140
		1250	1300	1850	1750	1250	1300	1850	1750	800	1140
10	680	1350	1350	2000	1800	1350	1350	1900	1800	900	1240
13	884	1400	1750	2200	2100	1400	1750	2050	2150	1000	1340
15	1020	1500	1800	2200	2150	1500	1800	2050	2200	1000	1340
16	1088	1500	1950	2250	2350	1500	1950	2150	2400	1000	1340

LIFT SPEED METERS / SEC.	PIT DEPTH	OVER HEAD MINIMUM	CLEAR (DOOR) OPENING	BELOW LENTIL FROM FINISHED FLOOR LEVEL
0.7 to 1.0	1600	4800	2000	2260
1.25	1600	5000	2100	2360
1.5	1800	5500	2200	2460

NOTE :-

- All dimensions are in millimeters.
- All dimensions are for clear finished lift walls after plastering.
- All walls minimum 150 RCC or 230 brick (hoist way front wall 230 brick preferred).
- RCC machine room structural floor slab 150 thick designed to sustain minimum 1000 Kg./ M²UDL.
- Power supply 400 volts, 3 phase, 4 wires, 50Hz and 230 volts 1 phase terminating in a MCCB/ ELCB switch to be provided by clients.
- for specific requirements our local representative will be happy to work with you in a preparation of working drawings.

PASSENGER ELEVATOR (MACHINE ROOM LESS)

LIFT WELL ELEVATION

LIFT WELL PLAN (CENTER OPENING DOORS)

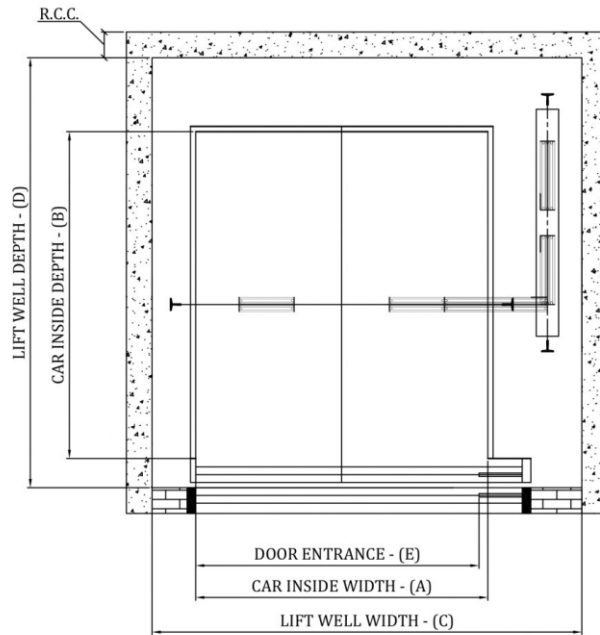

MANUAL DOOR
CROSS SECTION PLAN OF ELEVATOR SHAFT

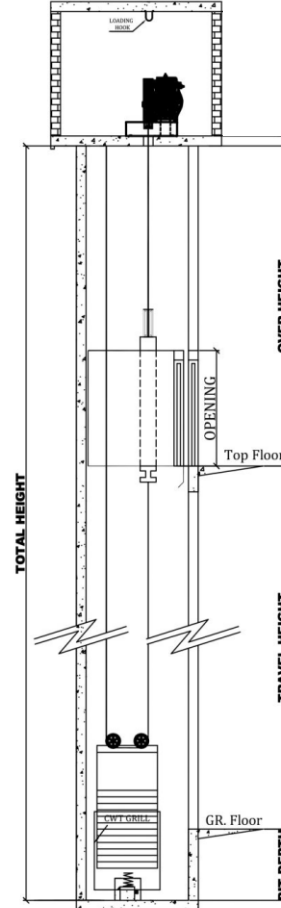

ELEVATION OF ELEVATOR

CAPACITY	CAR INSIDE (Center Opening)	LIFT WELL (Center Opening)		CAR INSIDE (Side Opening)		LIFT WELL (Side Opening)		ENTRANCE	SHIFT OPENING		
		PERSONS	Kgs.	WIDTH	DEPTH	WIDTH	DEPTH			WIDTH	DEPTH
4	272	800	900	1400	1350	800	900	1400	1400	700	1040
5	340	1000	900	1600	1350	1000	900	1550	1400	700	1040
6	408	1000	1100	1800	1500	1000	1100	1550	1550	800	1140
		1100	1000	1800	1450	1100	1000	1650	1450	800	1140
7	476	1200	1050	1800	1450	1200	1050	1800	1500	800	1140
8	544	1100	1300	1800	1650	1100	1300	1700	1700	800	1140
		1200	1200	1800	1600	1200	1200	1800	1600	800	1140
9	612	1200	1350	1800	1800	1200	1350	1800	1800	800	1140
		1250	1300	1850	1750	1250	1300	1850	1750	800	1140
10	680	1350	1350	2000	1800	1350	1350	1900	1800	900	1240
13	884	1400	1750	2200	2100	1400	1750	2050	2150	1000	1340
15	1020	1500	1800	2200	2150	1500	1800	2050	2200	1000	1340
16	1088	1500	1950	2250	2350	1500	1950	2150	2400	1000	1340

LIFT SPEED METERS / SEC.	PIT DEPTH	OVER HEAD MINIMUM	CLEAR (DOOR) OPENING	BELOW LENTIL FROM FINISHED FLOOR LEVEL
0.7 to 1.0	1600	4800	2000	2260
1.25	1600	5000	2100	2360
1.5	1800	5500	2200	2460

NOTE :-

1. All dimensions are in millimeters.
2. All dimensions are for clear finished lift walls after plastering.
3. All walls minimum 150 RCC or 230 brick (hoist way front wall 230 brick preferred).
4. Power supply 400 volts, 3 phase, 4 wires, 50Hz and 230 volts 1 phase terminating in a MCCB/ ELCB switch to be provided by clients.
5. for specific requirements our local representative will be happy to work with you in a preparation of working drawings.



GLASS/ CAPSULE ELEVATORS

Glass/ Capsule Elevator is one that works under the principles of pneumatics and vacuum, composed of a vertical cylindrical duct and a car that moves inside.

Advantages

Advantages of Glass/ Capsule Elevators by Bharat Elevators

- **Greater Integration Possibilities** - Glass/ Capsule elevators are much more versatile than traditional single-family elevators since they allow their integration in areas of the home where the installation of non-panoramic elevators would be very visually and spatially invasive.
- **Design** : Make no mistake, we install an elevator in our single-family home once in a lifetime. If we give importance to the design of the furniture, the kitchen, the color of the walls, or the sofa..., why not give it to an element that will exponentially increase both our quality of life and the value of our residence? Combining its personality with that of our home, the installation of panoramic elevators in single-family homes almost always supposes having the character of its technological project.
- **Use of Light** : By having a transparent structure, the glass/ capsule elevators allow the passage of light.
- Avoid feeling overwhelmed when using the elevator. everyone knows that many people have a phobia of riding in an elevator. what's more, if you didn't know, we'll tell you!
- The reason that most elevators have a mirror is precisely to avoid that feeling of overwhelm or claustrophobia that many people experience during elevator tours. if we also consider that the size of single-family lifts is usually small (since what we always want is to make the most of the useful built surface), all the more reason to consider installing panoramic lifts that eliminate this problem at a stroke. Glass/ Capsule Elevators manufacturers in Delhi-NCR

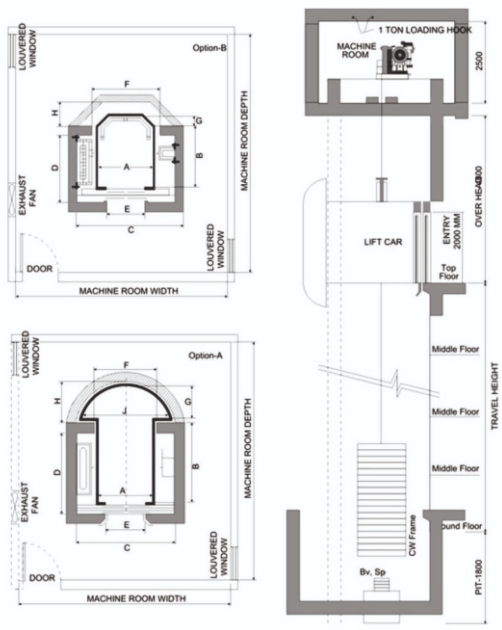

Technical information

These elevators are the most innovative system by making use of a suction system that extracts air from the upper area of the duct through which they move, thus creating a pressure difference between the lower and upper areas. It causes the cabin to rise with its occupants.





HOSPITAL/ BED ELEVATORS

The hospital/ bed elevators for hospitals become an indispensable element that helps to better manage any type of transfer. Mobility must be done quickly and efficiently when we talk about people's health.

Advantages

Advantages of Hospital/ Bed Elevators by Bharat Elevators

- **ACCESSIBILITY** - Hospital/ Bed Elevators have to ensure that they can be accessed by anyone. These types of lifts have to be designed in such a way that they allow, without any type of obstacle, the entrance and exit of the stretchers quickly: therefore, it is important that the size of the car, the way the doors open, and that the level of the floor is adequate. Also, the elevators have systems that detect people and any other type of obstacle.
- **SECURITY** : This type of elevator must follow the same security measures as any other conventional elevator, as it is a mandatory requirement that comply with the regulations. As pertinent safety elements, hospital elevators have : a telephone to communicate with the emergency service of the maintenance company(24hours), alarm buttons, emergency lights, as well as fire protection and safety regulations.
- **COMFORT** : Users of this type of lift must be guaranteed good comfort. it is therefore essential that the elevator is low noise and that the change between floors occurs smoothly, as well as avoiding any sudden movement when starting or braking the elevator.
- **HYGIENE** - We will all agree on how important hygiene is, especially in hospitals. the elevators found in these centers must be subjected to adequate maintenance, cleaning, and disinfection established according to the requirement recorded in the guide of each hospital center. Among these requirements we can mention the use of antibacterial materials in the cabin, waterproofing of the elevator pit to avoid humidity, incorporation of ventilation systems, etc.



Technical information

It is that the installation of emergency hospital/ bed elevators in public buildings such as hospitals is mandatory. These elevators are used to carry patients on a wheelchair or stretcher without jerks and shocks.





GOODS/ FREIGHT ELEVATORS

Goods/ Freight Elevators, it is made with a heavy-duty brushed stainless steel sheet with an acrylic plate and fan and a railing with LED light. It can be used to transport cargo in a variety of environments. Goods/ Freight Elevators are made with heavy-duty brushed stainless steel sheets with acrylic plates and fan and railing with LED light.

Advantages

Advantages of Goods/ Freight Elevators by Bharat Elevators

- These kinds of elevators are ideal elements for companies requiring the mobility of heavy goods. because this product has the necessary structures so that these processes of moving products from one place to another. In your company or business are easier and more effective. Now you won't have to worry, because this lift does this job for you.
- These Elevators are made of materials that resist high impacts and are subject to continuous efforts. Its structure makes it fully functional for this type of heavy load work, also It offers you different advantages that are essential such as:
 - Safety for cargo: Reduces accidents, Damages, or Losses.
 - Safety for personnel : employees will no longer have to carry heavy goods, which prevents injuries to different part of the body.
 - Saving Money : Production levels can be more effective because the load will be transported without risk and faster.
 - Time-Saving : The lift will take care of all the work of transporting cargo, so you can organize your time on other tasks.

Product information

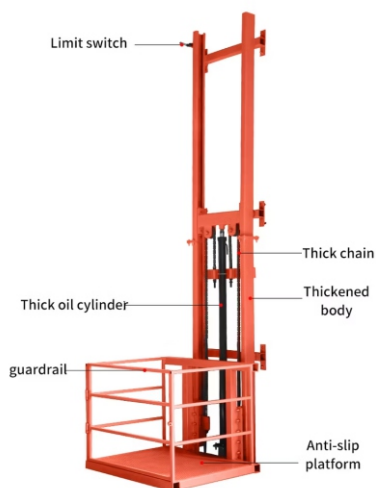

Technical information

It is widely used for ports, factories, businesses, supermarkets and hotels, and other large logistics places. small size, lightweight gearless traction machine saves construction space, greatly improves the performance and quality of freight elevators and reduces the failure rate. The robust bottom of the car can reliably support all kinds of loads, the high-precision weighing switch strictly controls the load in case of overload.



FREIGHT ELEVATOR [MACHINE ROOM]

LIFT WELL & MACHINE ROOM PLAN

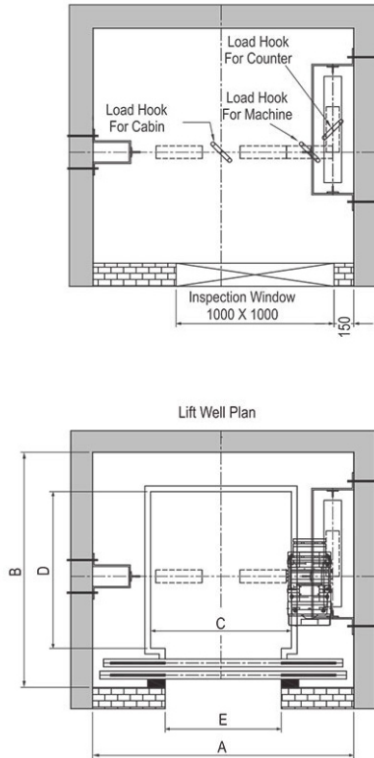

LIFT WELL ELEVATION

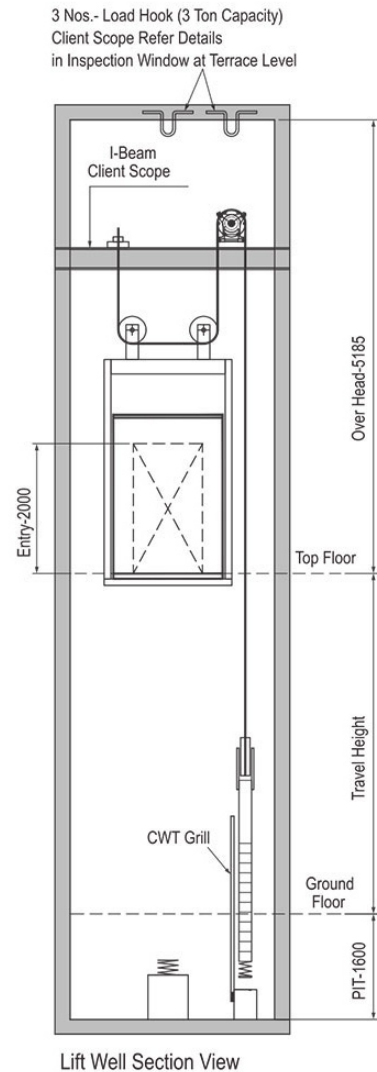

MANUAL OPERATED DOORS :

CAPACITY	CAR INSIDE		LIFT WELL		ENTERANCE	
	Kgs.	WIDTH	DEPTH	WIDTH	DEPTH	WIDTH
525	1100	1200	1800	1600	1000	2000
750	1200	1600	1900	2000	1000	2000
1050	1400	1800	2100	2200	1200	2000
1500	1700	2000	2400	2400	1500	2000
2025	1800	2500	2550	2900	1600	2000
2550	2000	2600	2800	3000	1800	2000
3000	2200	3000	3000	3400	2000	2000
3525	2200	3500	3000	3900	2000	2100
4050	2500	3500	3300	3900	2200	2100
5025	2600	4000	3400	4400	2300	2100

AUTOMATIC DOORS :

CAPACITY	CAR INSIDE		LIFT WELL		ENTERANCE	
	Kgs.	WIDTH	DEPTH	WIDTH	DEPTH	WIDTH
525	1100	1200	1875	1750	1000	2000
750	1200	1600	1950	2150	1000	2000
1050	1400	1800	2200	2350	1200	2000
1500	1700	2000	2550	2550	1500	2000
2025	1800	2500	2750	3050	1600	2000
2550	2000	2600	3000	3150	1800	2000
3000	2200	3000	3250	3550	2000	2000
3525	2200	3500	3250	4050	2000	2100
4050	2500	3500	3550	4050	2200	2100
5025	2600	4000	3650	4550	2300	2100

CAPACITY	LIFT SPEED METERS/ SEC.	PIT DEPTH	OVER HEAD	CLEAR(DOOR) OPENING	BELOW LENTIL FROM MANUAL	BELOW LENTIL FROM AUTOMATIC
525 TO 2525 Kgs.	0.25 to 0.50	1600	4600	1000	2250	2460
2525 TO 4000 Kgs.	0.25 to 0.32	1800	4800	2000	2250	2460

NOTE :-

- All dimensions are in millimeters.
- All dimensions are for clear finished lift walls after plastering.
- All walls minimum 150 RCC or 230 brick (hoist way front wall 230 brick preferred).
- RCC machine room structural floor slab 150 thick designed to sustain minimum 1000 Kg./ M²UDL.
- Power supply 400 volts, 3 phase, 4 wires, 50Hz and 230 volts 1 phase terminating in a MCCB/ ELCB switch to be provided by clients.
- for specific requirements our local representative will be happy to work with you in a preparation of working drawings.



Car Finishes And Designs

Cabins standard



ECB171



ECB112

Ceiling standard

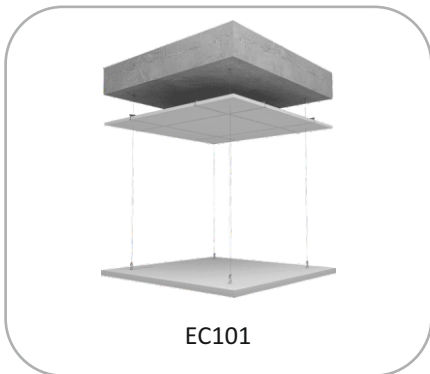

EC101



EC802

Ceiling Optional



EFC11



EFC14



EFC42

This picture is for reference only, the actual product may vary according to requirements





BHARAT ELEVATORS



SS DOORS



MANUAL DOOR

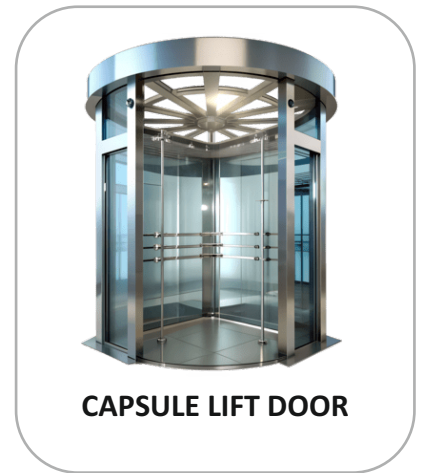

CAPSULE LIFT DOOR



LANDING DOOR



GLASS DOOR



GLASS DOOR



Manual Telescopic Door Swing Door

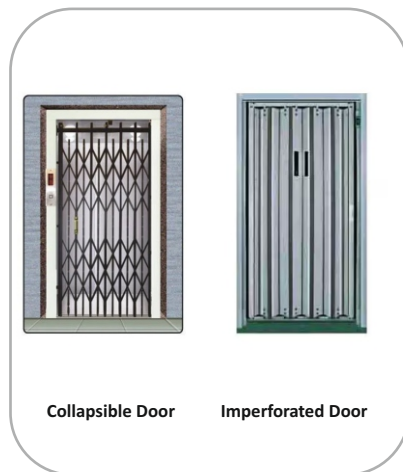

Collapsible Door Imperforated Door



ALUMINUM DOOR



BUILT FOR SAFETY, DESIGNED FOR YOU.

BHARAT ELEVATORS

Rz -7, Part - 3, Near Durga Mandir, Uttam Nagar West, Delhi 110059
+91-99961-21234, 96505-55409



Automatic Fermator Header



Telescopic Header



Wittur Automatic Header



Elevator Overload Sensor



Monarch Gear Panel



Car Operating Panel



Landing Operating Panel



This picture is for reference only, the actual product may vary according to requirements





MRL MACHINE

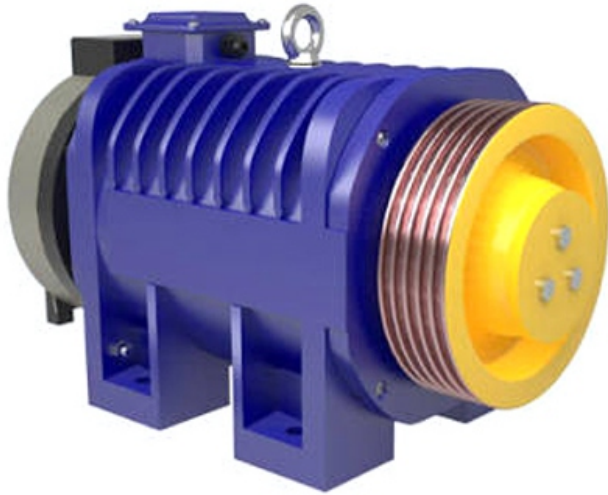

RANGE OF MRL

SPEED

0.32 TO 1.5 MPS

ROPING

2 : 1

ROPE DIA

8 MM

SHEAVE DIA

2 : 1

SPECIAL FEATURES
44 & 66 POLES MOTORS
AVAILABLE

PASSENGER CAPACITY 04 - 26

LOAD CAPACITY UP TO 5 TONNES



GREEN ENVIRONMENTAL PROTECTION



SPACE SAVING



EFFECTIVE AND ENERGY - SAVING



LOW NOISE

RANGE OF MRL

SPEED
UP to 1 MPS

ROPING
2 : 1

ROPE DIA
10 / 13 / 16 mm

SHEAVE DIA
400 / 520 / 640 mm



TRACTION MACHINE

TECHNICAL DETAILS

SPEED
0.5 to 1 MPS

ROPING
1 : 1 : 2 : 1

ROPE DIA
10 to 13 MM

SHEAVE DIA
in inch 21, 22, 25



NOTES



BHARAT ELEVATORS

Corporate Office and Manufacturing

Rz -7, Part - 3, Near Durga Mandir, Uttam Nagar West , Delhi 110059

Mobile : +91- 99961-21234, 96505-55409

Email :

Branch Offices : Delhi, Haryana, Chandigarh

This brochure has been prepared for the purpose information about BHARAT ELEVATORS and its parts.
The picture shown therein are for illustration purpose only and the products actually offered not resemble
The picture but shall maintain BHARAT assured quality standards.